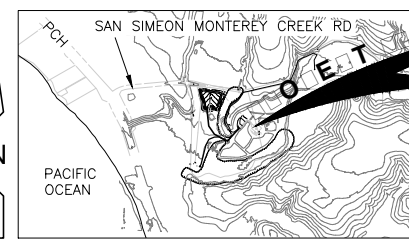
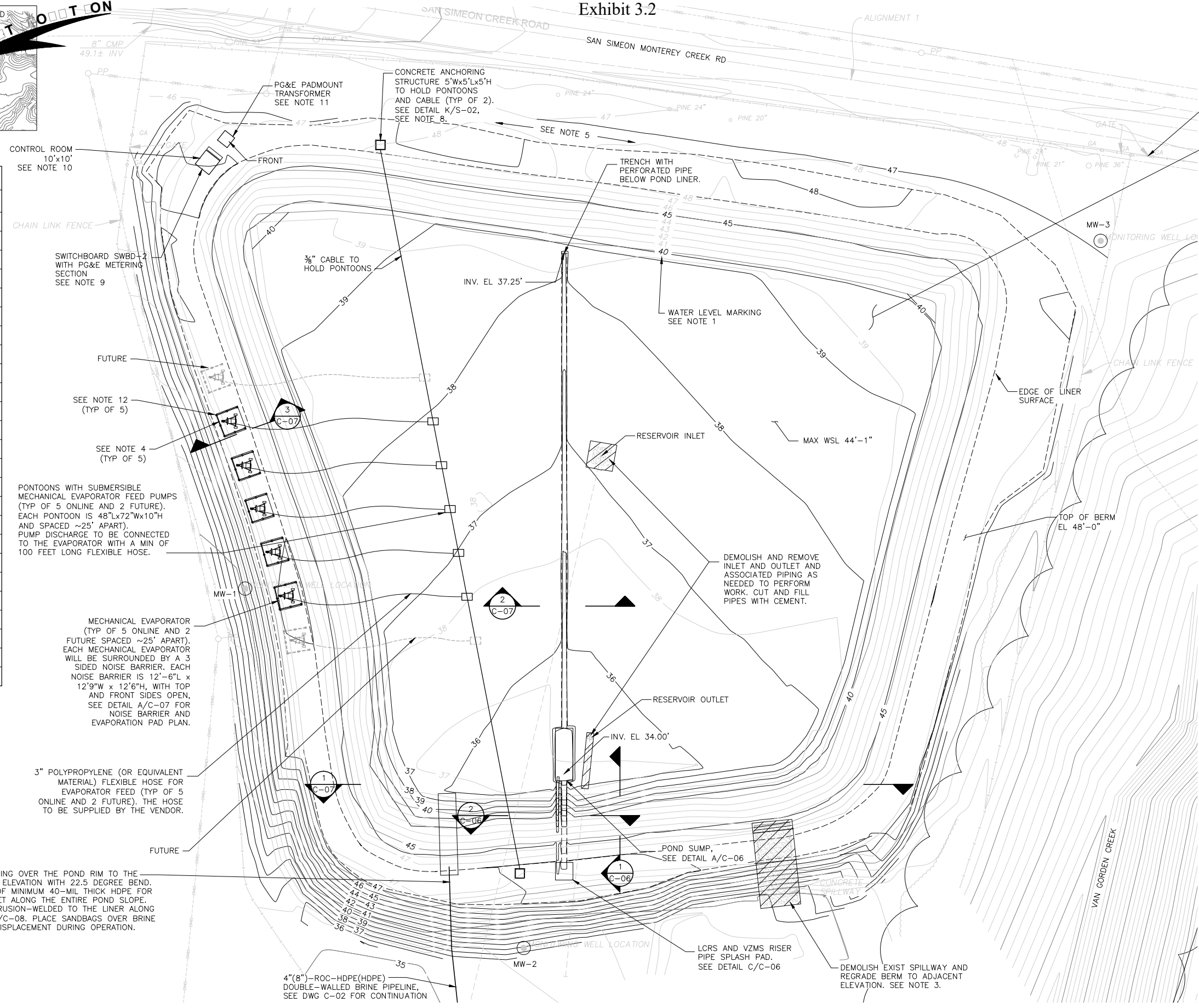

Exhibit 3.2



COORDINATES		
#	NORTHING	EASTING
100	NOT USED	NOT USED
101	NOT USED	NOT USED
102	2418887.0764	5633844.9715
103	2418879.2448	5633838.7533
104	NOT USED	NOT USED
105	NOT USED	NOT USED
106	NOT USED	NOT USED
107	NOT USED	NOT USED
108	NOT USED	NOT USED
109	NOT USED	NOT USED
110	NOT USED	NOT USED
111	NOT USED	NOT USED
112	2418892.8005	5633851.4317
113	2418898.2827	5633855.7844
150	2418472.1201	5634021.3430
151	2418892.4811	5633941.8378
152	2418887.4811	5633941.8378
153	NOT USED	NOT USED
154	2418527.4956	5634049.1664
155	2418557.4956	5634049.1664
156	2418480.9146	5634044.1664
157	2418480.9146	5634054.1664
158	2418477.1201	5634021.3430
159	2418828.2835	5634049.1693
200	2418637.0459	5633867.2632



EX FENCE AND GATE
 EVAPORATION POND TO BE LINED WITH IMPERMEABLE HDPE LAYER, LEACHATE COLLECTION AND REMOVAL SYSTEM (LCRS), AND VADOSE ZONE MONITORING SYSTEM (VZMS). REFER TO SHEETS C-6 THROUGH C-8 FOR DETAILS.

- NOTES:**
1. MARKINGS ON POND INTERIOR SHALL IDENTIFY ELEVATIONS EVERY FOOT. THE TEXT SHALL BE AT 2 FOOT INTERVALS AND BE 18" TALL; THE HORIZONTAL ELEVATION MARKINGS SHALL BE 6" TALL AND AT LEAST 3 FT WIDE.
 2. PROOFROLL AND COMPACT THE BOTTOM OF THE POND, SIDE SLOPE AND THE TOP OF BERM TO PROVIDE A COMPETENT SURFACE FOR SUPPORT OF THE LINER.
 3. REMOVE AND RECOMPACT THE UPPER 12 INCHES BELOW THE EXPOSED SUBGRADE OF THE DEMOLISHED SPILLWAY TO PROVIDE A COMPETENT SUBGRADE PRIOR TO PLACING FILL TO MATCH THE TOP OF THE ADJACENT BERM. ALL FILL SHALL BE COMPACTED TO AT LEAST 90 PERCENT RELATIVE COMPACTION IN ACCORDANCE WITH ASTM D1557 AT A MOISTURE AT LEAST 2 PERCENT HIGHER THAN OPTIMUM.
 4. REMOVE AND RECOMPACT THE FOOTPRINT TO PROVIDE A ZONE OF COMPACTED FILL FOR PAD SUPPORT. PROVIDE AT LEAST 2' OF COMPACTED FILL. THE FILL SHALL EXTEND AT LEAST 3' LATERALLY BEYOND THE LIMITS OF THE PAD.
 5. RE-GRADE AS NEEDED ON THE NORTH END TOP OF POND TO PREVENT STORM WATER RUNOFF FROM ENTERING THE POND. FLOWS CAN BE DIRECTED TO THE EAST AS NEEDED.
 6. PROVIDE GASOLINE-POWERED LCRS DEWATERING PUMP FOR USE AS-NEEDED, GODWIN MODEL GWP-50HX WITH WHEEL KIT OR APPROVED EQUAL TO BE STORED IN AWTP CONTROL ROOM CONTAINER. PROVIDE CABLE WATER LEVEL METER TO MONITOR WATER LEVEL IN LCRS AND VZMS AS NEEDED, SOLINST MODEL 102M MINI WITH MINIMUM 75 FT CABLE LENGTH AND TYPE P1 PROBE, OR APPROVED EQUAL.
 7. PENETRATE FENCE AS NEEDED, PROVIDE KNUCKLED ENDS AROUND PIPE.
 8. RECOMPACT UPPER 12" BENEATH CONCRETE ANCHORING STRUCTURE TO AT LEAST 90% RELATIVE COMPACTION PER ASTM D1557.
 9. SWITCHBOARD SHALL BE CONSTRUCTED ON 18'x8'x12" CONCRETE SLAB PER DETAIL G/S-02.
 10. CONTROL ROOM SHALL BE CONSTRUCTED ON 12'x12'x12" CONCRETE SLAB PER DETAIL G/S-02.
 11. PG&E TRANSFORMER SHALL BE CONSTRUCTED ON 8'-2"x4"x12" CONCRETE SLAB PER DETAIL G/S-02.
 12. SPILL CONTAINMENT SLAB PER DETAIL A, C-07.

RECORD DRAWING

THIS RECORD DRAWING HAS BEEN PREPARED BASED ON A COMBINATION OF INFORMATION PROVIDED BY OTHERS AND BY CDM SMITH. TO THE BEST OF THE ENGINEER'S BELIEF AND KNOWLEDGE, THE INCLUDED RECORD INFORMATION IS REASONABLY ACCURATE.

By *Eun Chiu You* Date 5/20/16

CDM Smith

BRINE INLET PIPE, EXTENDING OVER THE POND RIM TO THE MAXIMUM WATER SURFACE ELEVATION WITH 22.5 DEGREE BEND. INSTALL 4FT WIDE STRIP OF MINIMUM 40-MIL THICK HDPE FOR LINER PROTECTION AT INLET ALONG THE ENTIRE POND SLOPE. THE STRIP SHALL BE EXTRUSION-WELDED TO THE LINER ALONG ALL EDGES PER DETAIL D/C-08. PLACE SANDBAGS OVER BRINE INLET PIPE TO PREVENT DISPLACEMENT DURING OPERATION.

XREFS: [CDMS_2234_CAMB-MF-0ASte_CAMB-MF-0IS-Road] Images: []
 Last saved by: NAHHASOM Time: 5/15/2014 8:08:00 PM
 C:\Users\Nahhasom\Desktop\CAMBRIA P&ID\GWA\C-05.dwg
 ©2014 CDM SMITH ALL RIGHTS RESERVED.
 REUSE OF DOCUMENTS: THESE DOCUMENTS AND DESIGNS PROVIDED BY PROFESSIONAL SERVICE, INCORPORATED HEREIN, ARE THE PROPERTY OF CDM SMITH AND ARE NOT TO BE USED, IN WHOLE OR PART, FOR ANY OTHER PROJECT WITHOUT THE WRITTEN AUTHORIZATION OF CDM SMITH.

REV. NO.	DATE	DRWN	CHKD	REMARKS
5	5/20/16	DI	ECY	RECORD DRAWING
4	10/6/14			REVISED POND BURY BRINE POND INLET PIPING
3	8/29/14			REVISED PER RWQCB COMMENTS
2	8/20/14			REVISED PER RWQCB COMMENTS
1	8/5/14	ON	ECY	REVISED PER TITLE 27 TM4

DESIGNED BY: E. SMITH
 DRAWN BY: O. NAHHAS
 SHEET CHK'D BY: R. CHALMERS
 CROSS CHK'D BY: E. YOU
 APPROVED BY: S. NEDIC
 DATE: JULY 23, 2014

WARNING
 0 1/2" 1"
 IF THIS BAR SCALE DOES NOT MEASURE 1" THIS DWG HAS BEEN REDUCED SCALE ACCORDINGLY

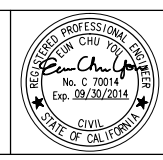

CAMBRIA EMERGENCY WATER SUPPLY PROJECT
 CAMBRIA COMMUNITY SERVICES DISTRICT

BRINE EVAPORATION POND PLAN

PROJECT NO. 138760-104133
 SHEET: 8 OF 38
 DRAWING NO. **C-05**

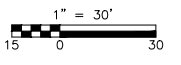
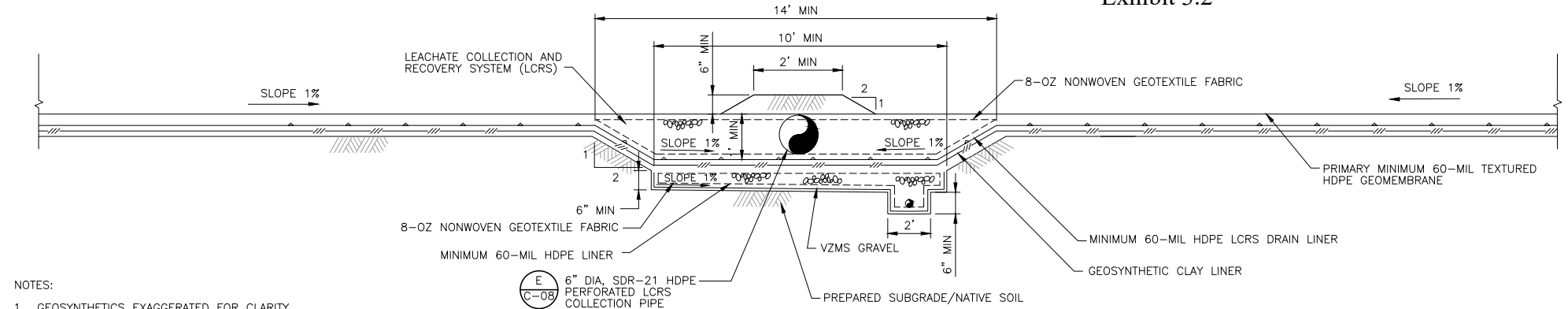
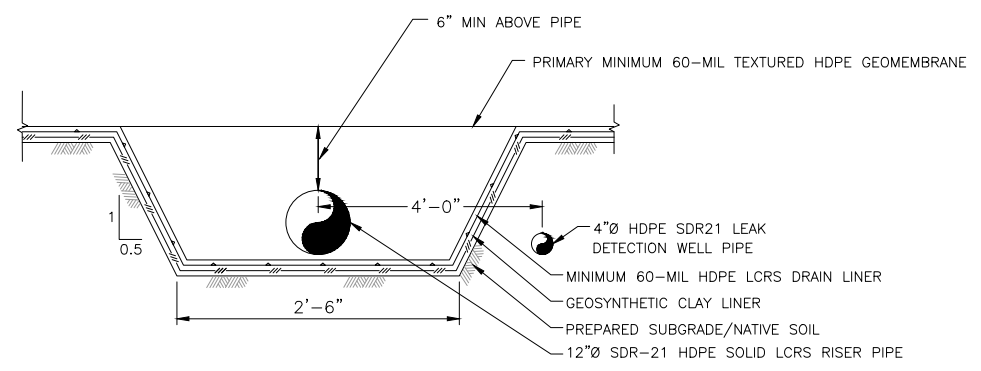

Exhibit 3.2



NOTES:
1. GEOSYNTHETICS EXAGGERATED FOR CLARITY.

TYPICAL POND SUMP
DETAIL
SECTION 1



TYPICAL RISERS PIPE TRENCH
SECTION 2

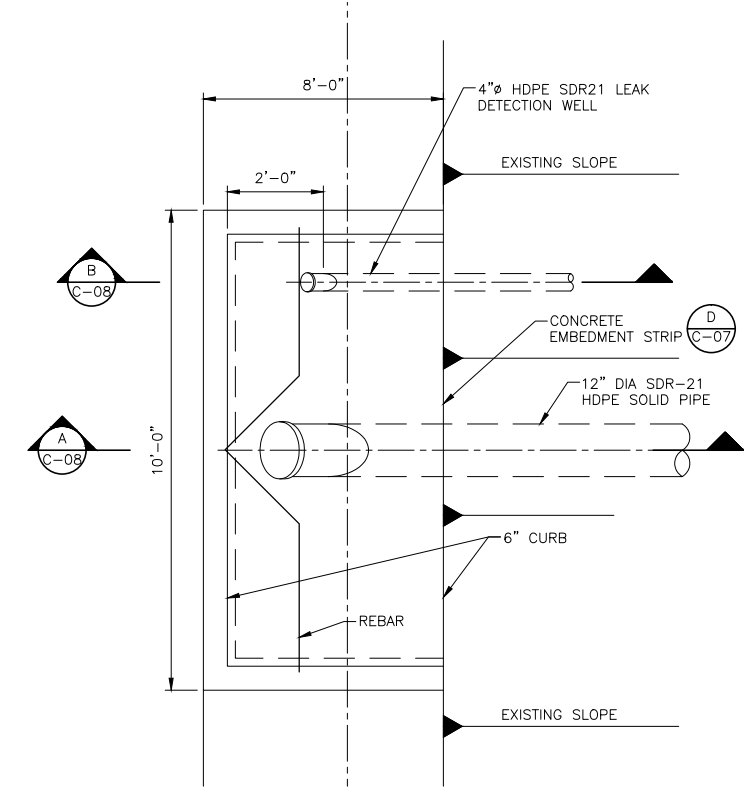

LCRS PUMP OUT RISERS PIPE
AND VZMS RISERS PIPE SPLASH PAD
DETAIL
SECTION C

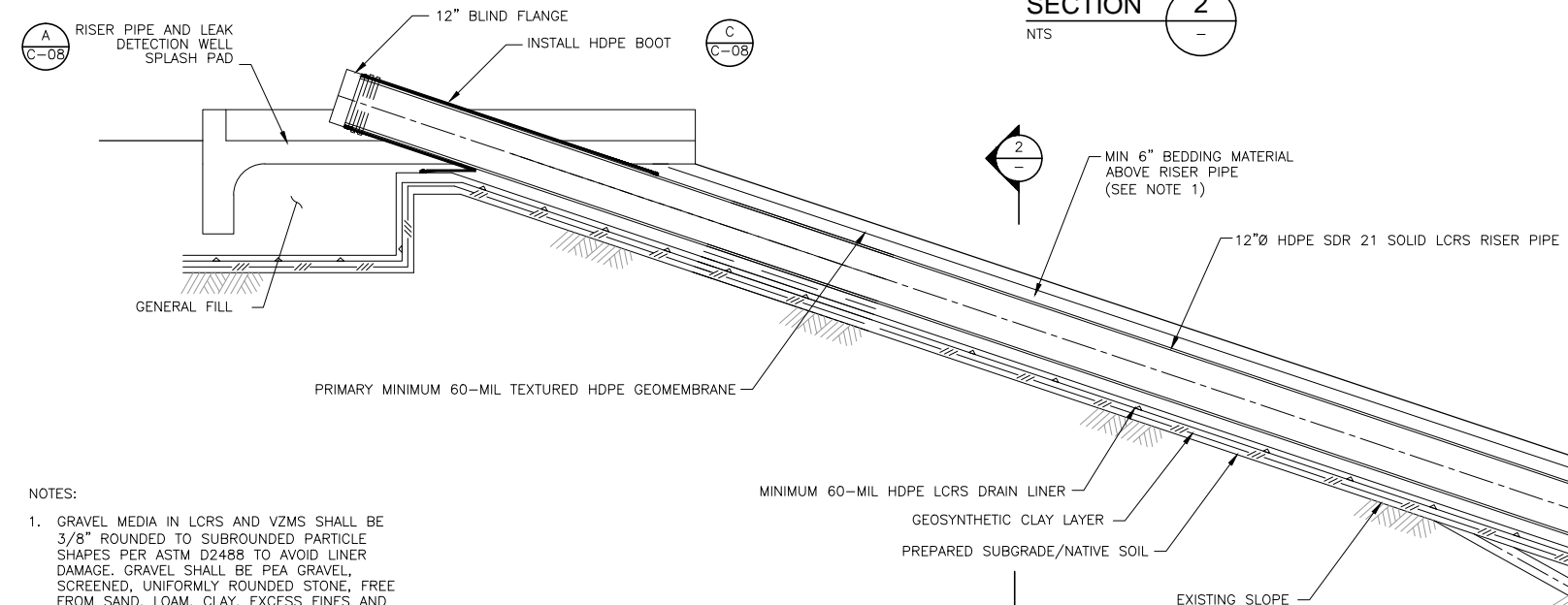

TYPICAL LONGITUDINAL SUMP
AT LCRS RISERS PIPE
SECTION 1

NOTES:
1. GRAVEL MEDIA IN LCRS AND VZMS SHALL BE 3/8" ROUNDED TO SUBROUNDED PARTICLE SHAPES PER ASTM D2488 TO AVOID LINER DAMAGE. GRAVEL SHALL BE PEA GRAVEL, SCREENED, UNIFORMLY ROUNDED STONE, FREE FROM SAND, LOAM, CLAY, EXCESS FINES AND OTHER DELETERIOUS MATERIALS. PEA GRAVEL SHALL CONFORM TO THE FOLLOWING GRADATION LIMITS:

SIEVE SIZE	PERCENT FINER BY WEIGHT
1/2-IN	100
3/8-IN	90
NO.4	25
NO.8	5
NO.16	0

GRAVEL SHALL HAVE CARBONATE CONTENT OF NO MORE THAN 1%.
GRAVEL SHALL HAVE DURABILITY INDEX OF NOT LESS THAN 40.

RECORD DRAWING

THIS RECORD DRAWING HAS BEEN PREPARED BASED ON A COMBINATION OF INFORMATION PROVIDED BY OTHERS AND BY CDM SMITH. TO THE BEST OF THE ENGINEER'S BELIEF AND KNOWLEDGE, THE INCLUDED RECORD INFORMATION IS REASONABLY ACCURATE.

By *E. You* Date 5/20/16

CDM Smith

REV. NO.	DATE	DRWN	CHKD	REMARKS
4	5/20/16	DI	ECY	RECORD DRAWING
3	10/6/14			REVISED PER RWQCB COMMENTS
2	8/29/14			REVISED PER RWQCB COMMENTS
1	8/20/14			REVISED PER RWQCB COMMENTS

DESIGNED BY: E. SMITH
DRAWN BY: O. NAHHAS
SHEET CHK'D BY: R. CHALMERS
CROSS CHK'D BY: E. YOU
APPROVED BY: S. NEDIC
DATE: JULY 23, 2014

WARNING
1/2" = 1"
IF THIS BAR SCALE DOES NOT MEASURE 1" THIS DWG HAS BEEN REDUCED SCALE ACCORDINGLY

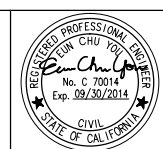

CAMBRIA EMERGENCY WATER SUPPLY PROJECT
CAMBRIA COMMUNITY SERVICES DISTRICT

BRINE EVAPORATION POND SECTIONS AND DETAILS I

PROJECT NO. 138760-104133
SHEET: 9 OF 38
DRAWING NO. **C-06**

XREFS: [CDMS_2234_CAMB-MF-06Site_CAMB-MF-06IS-Road] Images: []
Last saved by: NAHHASOM Time: 5/15/2014 8:14:11 PM
C:\Users\NahhasOM\Desktop\CAMBRIA\PI&ID\CW\C-06.dwg
©2014 CDM SMITH ALL RIGHTS RESERVED.
REUSE OF DOCUMENTS: THESE DOCUMENTS AND DESIGNS PROVIDED BY PROFESSIONAL SERVICE, INCORPORATED HEREIN, ARE THE PROPERTY OF CDM SMITH AND ARE NOT TO BE USED, IN WHOLE OR PART, FOR ANY OTHER PROJECT WITHOUT THE WRITTEN AUTHORIZATION OF CDM SMITH.